

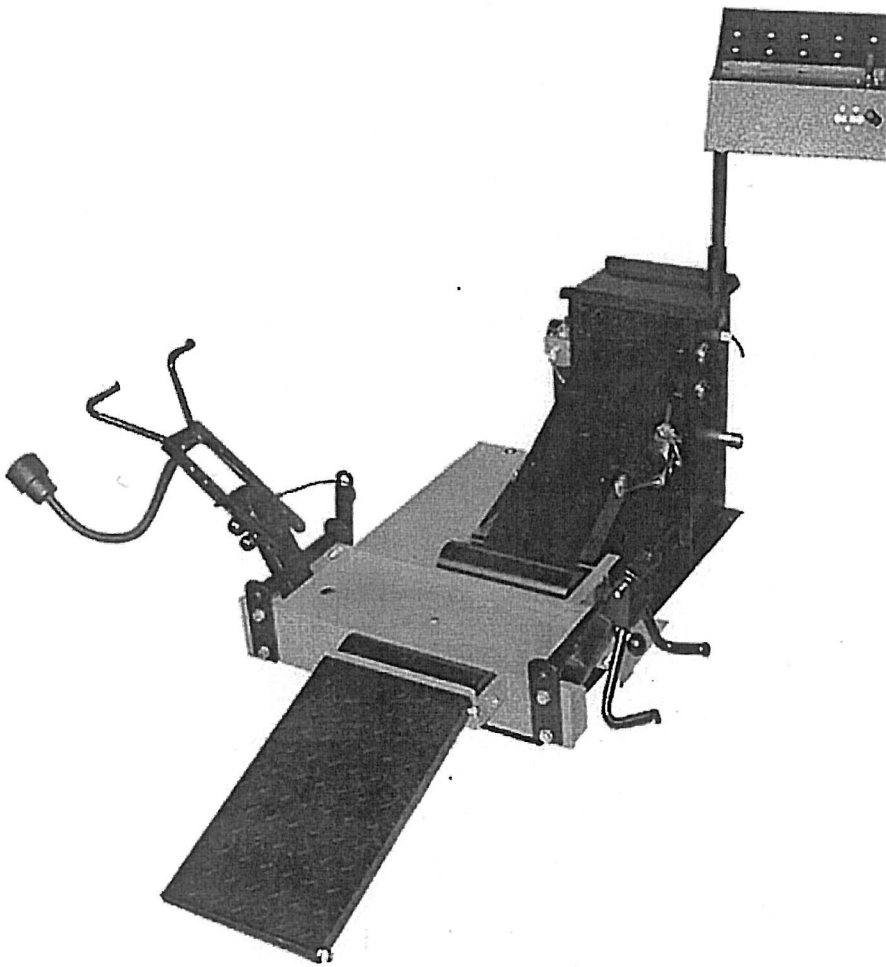

# Truck Tire Spreader Instruction Manual # 73200



## Warnings

AME International  
2324 Circuit Way  
Brooksville FL 34604  
Phone 352-799-1111 Fax 352-799-1112  
sales@ameintl.net

- Please read the instruction booklet and all directions on the machine carefully and fully understand the contents before use.
- This machine is used for spreading tires or repairing protective casing of tires only. It should not be used for other applications. AME is not responsible for any of consequences resulting from improper use.
- Keep the spreading hooks and claws clean in the process of spreading. Be careful to avoid grease or other foreign material, which may cause the hooks to be slick.
- Do not use the machine if it appears worn or twisted out of shape or if it's damaged. Contact AME or your distributor for parts or repair.
- All operators should wear protective coverings throughout the process.

## Product Illumination

Pneumatic tire spreader is designed to assist in fixing the tires and spreading the tires during repairing, in order to work for the tire polishing, cleaning and films affixed etc. Equipped with work light and tool rack to improve work efficiency, enable the tire repairing work to be more convenient and faster. Manifest personalized design.

## Technical Parameter

Tire Width: 145MM-75MM

Tire Diameter: 11"-4"

Input Voltage: 12V

Air Pressure: 100 PSI

## Product Structure Illumination

AME International  
2324 Circuit Way  
Brooksville FL 34604  
Phone 352-799-1111 Fax 352-799-1112  
sales@ameintl.net

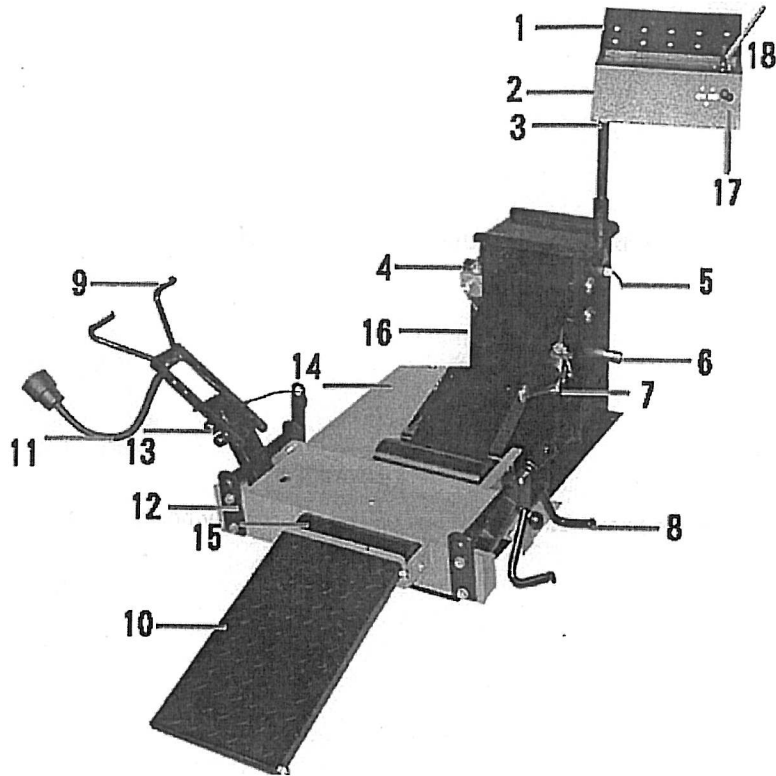

- |                                 |   |
|---------------------------------|---|
| (1)Tools Tray                   | (10) Tire platform                              |
| (2)Pneumatic control box        | (11) Work light                                 |
| (3)Tools racks                  | (12) Up & down platform                         |
| (4)Air regulator                | (13) Adjusting valve                            |
| (5)Main body power              | (14) Spread pneumatic cylinder                  |
| (6)Pneumatic union              | (15) Tire lever                                 |
| (7)Up & down pneumatic cylinder | (16) Pneumatic tools union                      |
| (8) Short Spread hook           | (17) Spread pneumatic cylinder control valve    |
| (9)Long spread hook             | (18) Up & down pneumatic cylinder control valve |

# Installation

1. Place this product on solid ground and keep it flat.
2. Remove the backboard of pneumatic control box from the inclined support board.

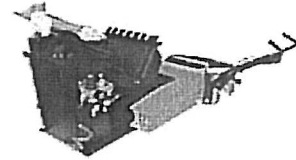

3. Take the fixed pin from the pneumatic control box.

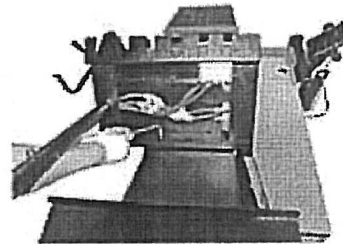

4. Put the pneumatic control box on the top of body box and adjust the well position.

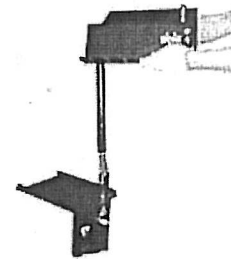

5. Connect the tools tray with pneumatic control box well.

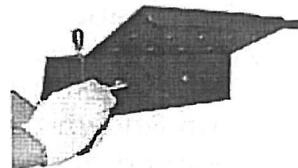

6. Connect the tire sloping board with equipments well.

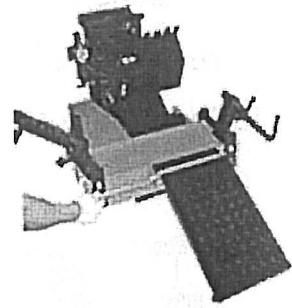

7. Connect the spread hook which equipped with work light with equipments.



8. Connect the short spread hook with equipments.



9. Connect a fast joint top at  $\frac{1}{4}$  normal temperature and moderate air pressure onto the fast joint top of the machine's air inlet. The minimum standard is to use  $\frac{1}{4}$  inch's wind pipe every 100 square inches.

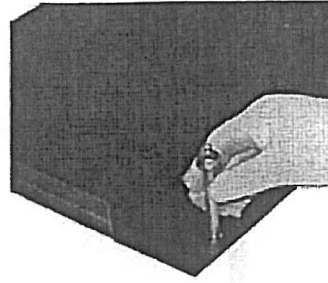

10. Keep it fixed on a flat ground with screws and keeps the screw firmness.

## Operation

1. Before starting the machine, check carefully whether the fasteners on the machine are loose because of transportation. If so tighten fasteners.
2. Fix the tire on the tire spreader with claw by hand.

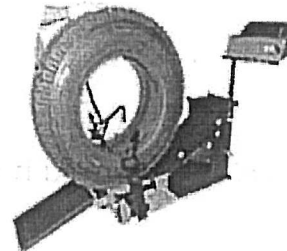
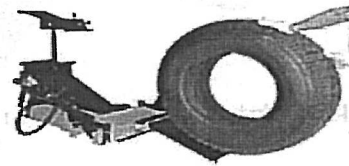

3. According to the size of the tire which needs to be repaired, to adjust the spreading claw to be the appropriate height. Place the spreading hook to link pin of the hanging device. Adjust the spreading hook up and down in order to insert into one of the adjusting holes which have 7 groups total. Put the short spread hook inside the tire and try to place the tire in the middle of tire lever if possible.

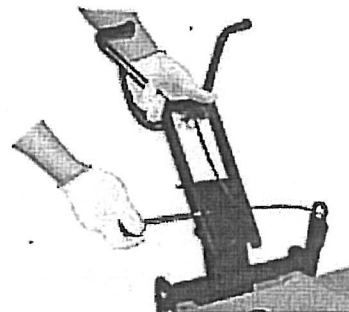
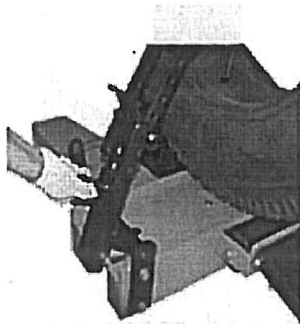

4. Pull the spreading control valve to the direction of spreading, and spread the tire to the width needed. The tire will probably disengage from the spreader if the spreading hook arm is too high. Operate after it is lowered and the height is properly adjusted.

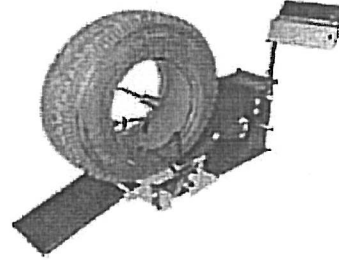
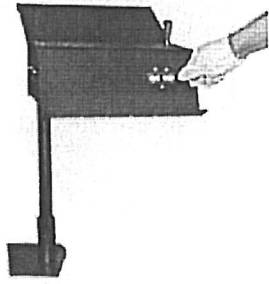

5. Pull the up & down control valve to the direction of up & down needed, raise the tire to the proper height.

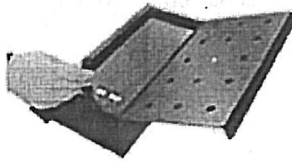

6. If it's needed to revolve the tire to a new position, please pull the spreading control valve to the direction of contraction, revolve the tire to a proper position on the machine after the spreading hooks are loosened, then operate the machine.

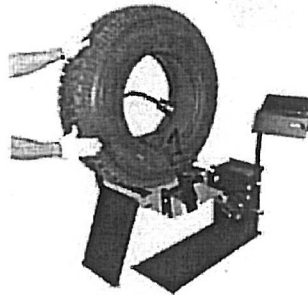

7. The work light fixed on the machine needs to be adjusted to a proper position, to illuminate the inside sufficiently and make the repair work easy.

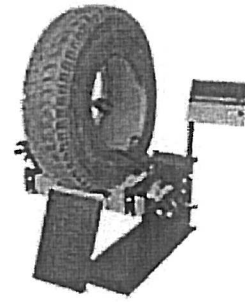
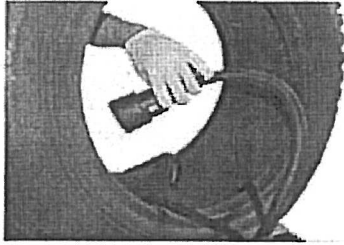

8. After finished maintenance work, please firstly move the up & down control valve to the downward direction, let the tire fall to the lowest, then move the up & down control valve to the direction of contraction, loosen the spreading hook and remove it from the tire core, then discharge the tire along the sloping board.

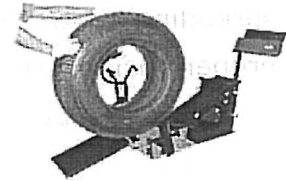
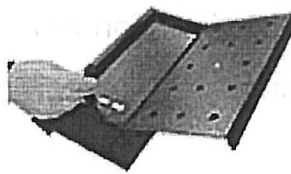
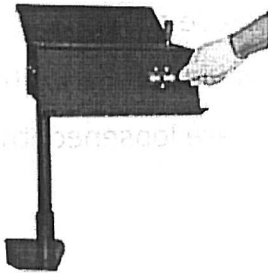



# Maintenance

- Add the lubrication oil to the oil cup in time, always guarantee that the oil quantity in the cup to be occupy  $1/3-2/3$  of the total volume. Adjust drip oil speed, piston reciprocating run every 5-6 times for drip one blob oil for standard. Ensure the oil pathway lubricates fully.
- Clear away the dust and sundries always, check whether the fastener is loose or not.
- Drip oil to the piston rod and the various parts of pin regularly. This will reduce friction, extending machine life.

# Caution

Before using the product, be sure to carefully read and fully understand the instructions manual and all stickers noted on the product. This is a necessary step to avoid injury to the operator and keep from damaging the product.

This product is designed only for spreading and the repairing of the tire. Do not use this product for any other purpose; AME is not responsible for any problems caused during misuse of the spreader.

Keep the hook and claw of the machine clean during operation. Clean away any dirt or debris, such as grease or lubricant, in order to avoid injury to the operator.

Do not use this product if it is visibly worn, broken, or damaged. Contact your distributor or AME for technical assistance or for replacement parts.

Appropriate eye protection should be worn at all times when working with the spreader. This product should only be used by trained professionals.

## Product Illumination

This vertical pneumatic car tire spreader is designed for fixing tires and spreading tires during repair, in order to work for tire patching and cleaning, this unit is equipped with a work light and tool rack to improve work efficiency, and also make repair work be faster and more convenient.

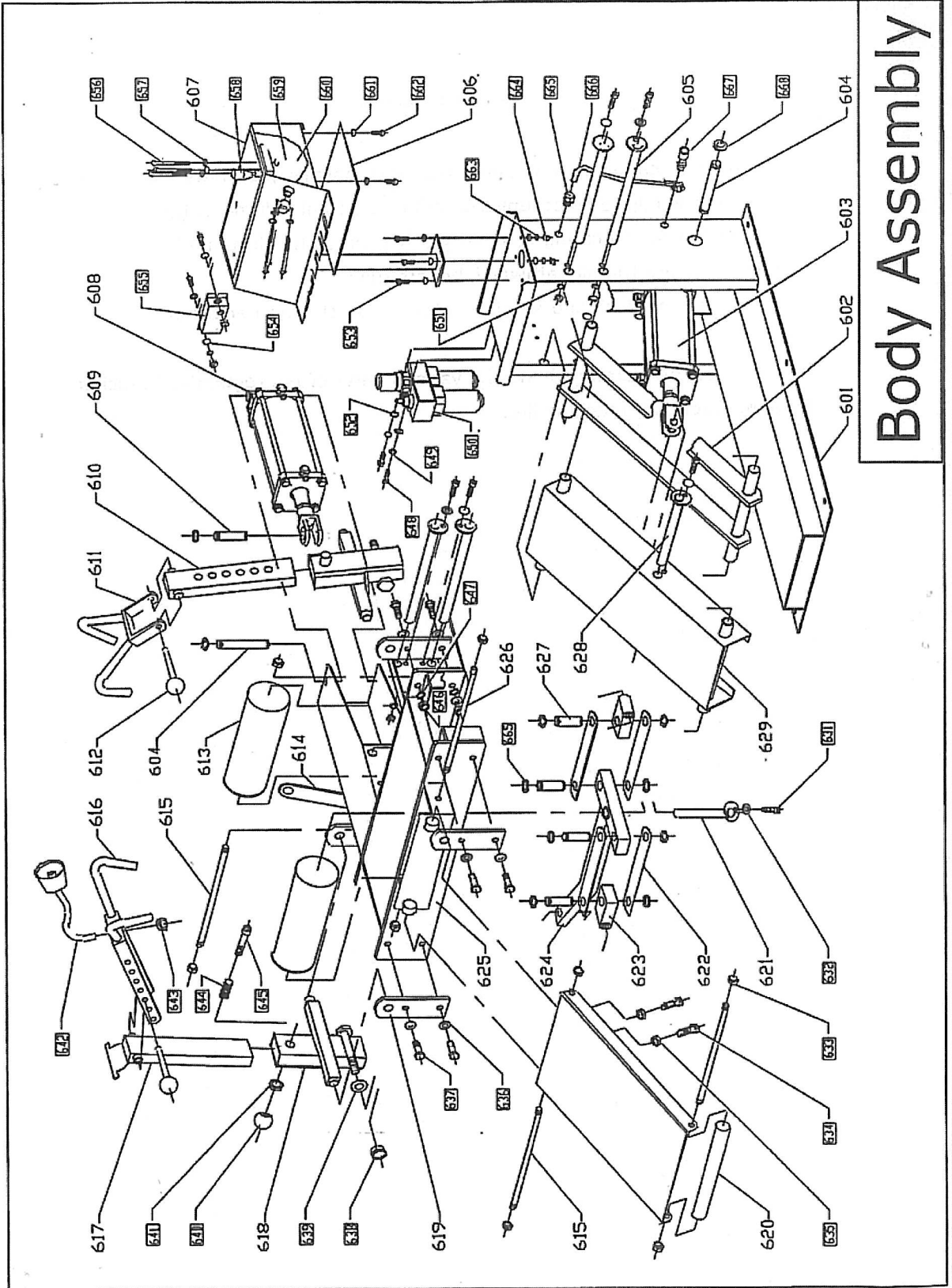

# Body Assembly

AME International  
 2324 Circuit Way  
 Brooksville FL 34604  
 Phone 352-799-1111 Fax 352-799-1112  
 sales@ameintl.net

| No.       | Description                            | QTY |
|-----------|--|-----|
| 73200-601 | Body                                   | 1   |
| 73200-602 | Swinging frame                         | 1   |
| 73200-603 | Up pneumatic cylinder                  | 1   |
| 73200-604 | Pneumatic cylinder shaft               | 2   |
| 73200-605 | Shaft 1                                | 4   |
| 73200-606 | Motherboard of pneumatic control box   | 1   |
| 73200-607 | Pneumatic control box                  | 1   |
| 73200-608 | Spreading pneumatic cylinder           | 1   |
| 73200-609 | Connection union                       | 1   |
| 73200-610 | Adjustive pipe 1                       | 1   |
| 73200-611 | Short spread hook                      | 1   |
| 73200-612 | Alignment unite element                | 2   |
| 73200-613 | Lever unite element                    | 2   |
| 73200-614 | Power line bracket                     | 1   |
| 73200-615 | Staff shaft                            | 3   |
| 73200-616 | Long spread hook                       | 1   |
| 73200-617 | Adjustive pipe 2                       | 1   |
| 73200-618 | Swing Frame                            | 2   |
| 73200-619 | Branch Union                           | 4   |
| 73200-620 | Lever unite element                    | 1   |
| 73200-621 | Shaft 3                                | 1   |
| 73200-622 | Connection board                       | 4   |
| 73200-623 | Short pulling pole                     | 2   |
| 73200-624 | Pulling Pole                           | 1   |
| 73200-625 | Up & down bracket                      | 1   |
| 73200-626 | Shaft 2                                | 1   |
| 73200-627 | Connecting-rod shaft                   | 4   |
| 73200-628 | Shaft 2                                | 1   |
| 73200-629 | Swing cover                            | 1   |
| 73200-630 | Tools tray                             | 1   |
| 73200-631 | Column hexangular bolt M8x10           | 6   |
| 73200-632 | Washer 8                               | 6   |
| 73200-633 | Ceasing nut M12                        | 8   |
| 73200-634 | Hexangular bolt M8x30                  | 2   |
| 73200-635 | Hexangular nut M8                      | 7   |
| 73200-636 | Washer 12                              | 12  |
| 73200-637 | Hexangular bolt M12x40                 | 8   |
| 73200-638 | Ceasing nut M16                        | 2   |
| 73200-639 | Washer 16                              | 2   |
| 73200-640 | Handle ball B-M10x32                   | 2   |
| 73200-641 | Coarse thread Hexangular flat bolt M10 | 2   |
| 73200-642 | work light                             | 1   |
| 73200-643 | Hexangular flat bolt M10               | 1   |
| 73200-644 | Compressing spring                     | 2   |
| 73200-645 | Column hexangular bolt M10x50          | 2   |
| 73200-646 | Hexangular nut M12                     | 8   |

| No.       | Description            |       | QTY |
|-----------|------------------------|-------|-----|
| 73200-647 | Spring washer          | 12    | 2   |
| 73200-648 | Column hexangular bolt | M6x12 | 4   |
| 73200-649 | Spring washer          | 6     | 2   |
| 73200-650 | Air regulator          |       | 1   |
| 73200-651 | Spring washer          | 8     | 5   |
| 73200-652 | Big flat washer        | 6     | 2   |
| 73200-653 | Column hexangular bolt | M5x16 | 2   |
| 73200-654 | big flat washer        | 5     | 2   |
| 73200-655 | Electron transformer   |       | 1   |
| 73200-656 | Crossed set bolt       | M4x40 | 6   |
| 73200-657 | Washer                 | 4     | 12  |
| 73200-658 | Handle valve           |       | 2   |
| 73200-659 | Spring washer          | 4     | 6   |
| 73200-660 | Hexangular nut         | M4    | 6   |
| 73200-661 | Washer                 | 5     | 12  |
| 73200-662 | Column hexangular bolt | M5x10 | 4   |
| 73200-663 | Spring washer          | 5     | 2   |
| 73200-664 | Hexangular nut         | M5    | 2   |
| 73200-665 | Loop                   |       | 1   |
| 73200-666 | Power thread           |       | 1   |
| 73200-667 | Metal quick connector  |       | 1   |
| 73200-668 | Shaft spring loop      | 20    | 14  |
| 73200-669 | Washer                 | 6     | 4   |
| 73200-670 | Hexangular nut         | M6    | 2   |
| 73200-671 | Column hexangular bolt | M8x12 | 1   |

AME International  
2324 Circuit Way  
Brooksville FL 34604  
Phone 352-799-1111 Fax 352-799-1112  
sales@ameintl.net

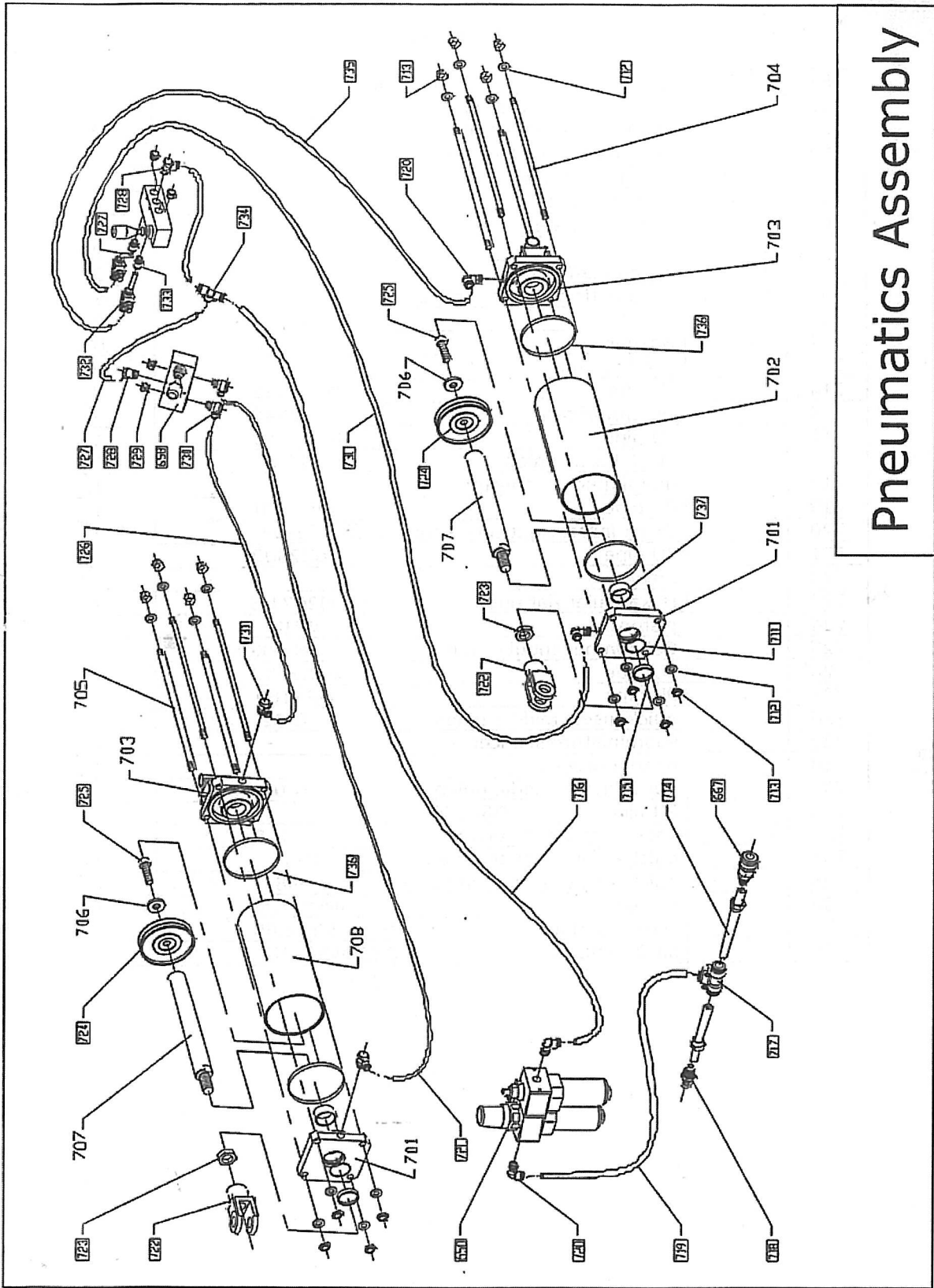

# Pneumatics Assembly

AME International  
 2324 Circuit Way  
 Brooksville FL 34604  
 Phone 352-799-1111 Fax 352-799-1112  
 sales@ameintl.net

| No.       | Description                        | Qty |
|-----------|------------------------------------|-----|
| 73200-667 | Metal quick connector              | 1   |
| 73200-701 | Pneumatic cylinder cover           | 2   |
| 73200-702 | pneumatic cylinder canister        | 1   |
| 73200-703 | Cylinder bottom                    | 2   |
| 73200-704 | Connecting staff                   | 4   |
| 73200-705 | Connecting staff                   | 4   |
| 73200-706 | Washer                             | 2   |
| 73200-707 | Piston staff                       | 2   |
| 73200-708 | Pneumatic culinder canister        | 1   |
| 73200-711 | O-Ring                             | 2   |
| 73200-712 | Washer                             | 16  |
| 73200-713 | Ceasing nut                        | 16  |
| 73200-714 | PU pipe                            | 2   |
| 73200-715 | Dustproof seal                     | 2   |
| 73200-716 | PU pipe                            | 1   |
| 73200-717 | Quick insert union                 | 1   |
| 73200-718 | Metal quick connector              | 1   |
| 73200-719 | PU pipe                            | 1   |
| 73200-720 | Quick insert right angle connector | 4   |
| 73200-721 | PU pipe                            | 1   |
| 73200-722 | Union                              | 2   |
| 73200-723 | Hexangular flat nut                | 2   |
| 73200-724 | Piston                             | 2   |
| 73200-725 | Column hexangular bolt             | 2   |
| 73200-726 | PU pipe                            | 1   |
| 73200-727 | PU pipe                            | 4   |
| 73200-728 | quick insert middle union          | 1   |
| 73200-729 | subminiature silencer              | 4   |
| 73200-730 | handle valve                       | 2   |
| 73200-731 | quick insert middle union          | 4   |
| 73200-732 | PU pipe                            | 1   |
| 73200-733 | speed adjusting union              | 2   |
| 73200-734 | quick insert straight union        | 2   |
| 73200-735 | quick insert upright union         | 1   |
| 73200-736 | PU pipe                            | 1   |
| 73200-737 | o rubber ring                      | 4   |
| 73200-738 | oil free piston                    | 2   |

AME International  
2324 Circuit Way  
Brooksville FL 34604  
Phone 352-799-1111 Fax 352-799-1112  
sales@ameintl.net